



GOVERNMENT OF INDIA
DEPARTMENT OF ATOMIC ENERGY
BHABHA ATOMIC RESEARCH CENTRE
VISAKHAPATNAM



Computational Analysis Division

Ref: CAD/HEDM/WO/IND/22-23/02

Date: 04/04/2022

Subject: Notice inviting tender for;

“ Fabrication, supply and installation of customized storage decks consisting of pallet racking system and adjustable shelving systems” (See Annexure-I).

1. Quotations are invited for minor fabrication job as per details described below.
2. **Scope of work:** See details in Annexure-I.
3. **General guidelines for submitting tender**
 - You shall send your offer in a **sealed envelope** indicating delivery period, price inclusive of taxes and other relevant information by speed post to:

Head,
CAD, Computational Analysis Division
Bhabha Atomic Research Centre
Village: Maduturu (Sub: P.O.)
Near Nagavaram Junction,
Gajuwaka-Yellamanchilli Highway
Atchutapuram, Visakhapatnam
Andhra Pradesh- 531011

(Kind Attention: Rahulnath P.P., SO/D,CAD, 0891-283-2149/ 8985875318)

- Quotation shall reach us on/or before **30/04/2022 by Speed Post/Courier/ Only.**
 - On top left corner of the envelope please indicate Quotation for– **“Fabrication, supply and installation of customized storage decks ”** And due date 30/04/2022
 - Overwriting, scratching etc. must be avoided in the quotation. Rewriting the whole figure shall carry out any alteration in the figure. The authorized person from the firm shall countersign such figure.
 - The delivery period mentioned in the quotation shall be strictly adhered to. If the contractor fails to supply and secure extension of delivery date before effecting delivery of the supply against the contract, acceptance of such item by the purchaser will in no way prejudice the right of the purchaser to levy liquidated damage nor will it be entitled to the contractor for payment of statutory levies that comes into force after the expiry of the delivery date.
 - Minimum Guarantee/**Warranty period** of the material and workmanship shall be **One Year.**
 - **Supplier shall mention clearly the PAN /TAN no. on quotation.**
 - **GST number shall be clearly mentioned on Quotation.**
 - All the charges and taxes shall be mentioned clearly.
- Please note that BARC being an R&D institution, GST rates are as follows
- For Intra-state Supply of Goods: @ 2.5% SGST + 2.5% CGST
 - For Inter-state Supply of Goods: @ 5.0% IGST
 - **GST exemption certificate shall be issued to the supplier.**

(This is as per Office Order No. BARC/GST/12/2017 dt. 27.12.2017)

- You may contact us for any clarification before 30/04/2022 (Shri. Rahulnath P.P., 0891-2832149,8985875318, rahulnath@barc.gov.in)

4. Rates:

As per Scope of Work.

5. Place of Delivery/Work:

Address: PEB-04,CAD, Bhabha Atomic Research Centre, Near Nagavaram Junction, Gajuwaka-Yellamanchilli Highway, Maduturu PO, Visakhapatnam, Andhra Pradesh- 531011.

5. PAYMENT TERMS:

- Part payment/Advance or against delivery cannot be made.
 - Payment will be made only after satisfactory completion of work and on production of (along with Delivery Challan):
 - Bill/Invoice containing Location of supply, separate tax components along with PAN and GSTN numbers.
 - Advance Stamped Receipt.
 - Bank Account No, Bank and Branch name with IFSC code.
 - Undertaking stating that GST has been promptly deposited with the authorities
 - It may be noted that:
 - Income tax @2% will be deducted from your bill.
 - TDS (under GST) will be deducted as applicable from your bill of taxable goods and/or services, where the total value of such supply exceeds 2.50lakh.
 - Declaration confirming filing of Income Tax Return from immediate two preceding years, in accordance with Section 206 AB of the Income Tax Act 1961, has to be submitted in the prescribed proforma along with necessary acknowledgements in support of declaration. In case the aforesaid declaration is not submitted, TDS/TCS shall be deducted at higher rates as instructed under the provisions of Income Tax Act.
- 6. CONFIDENTIALITY CLAUSE:**
- No, party shall disclose any information to any third party, concerning the matters under this contract generally. In particular, any information identified as "Proprietary" in nature by the disclosing party shall be kept strictly confidential by the receiving party and shall not be disclosed to any third party without the prior written consent of the original disclosing party.
- This clause shall apply to the sub-contractors, consultants, advisers or the employees engaged by a party with equal force.
- "Restricted information "categories under section 18 of the Atomic Energy Act,1962 and "Official Secrets" under section 5 of the official secrets act, 1923.
- Any contravention of the above-mentioned provisions by any contractor, sub-contractor, consultant, adviser or the employees of a contractor will invite penal consequences under the aforesaid legislation.
- Prohibition against use of BARC's name without permission for publicity purposes. The contractor or sub-contractor, consultant, adviser or the employees engaged by the contractor shall not use BARC's name for any publicity purpose through any public medial like press, radio, T.V. or Internet without the prior written approval of BARC.



(Rahulnath P.P.)
SO/D, CAD

Phone: 0891-2832149,

Email: rahulnath@barc.gov.in

Scope of work**Fabrication, supply and installation of customized storage decks consisting of pallet racking system and adjustable shelving systems**

The following items are to be fabricated and installed;

| Sl. No. | Item | Drawing No. | Quantity |
|---------|--------------------------------------|-------------|----------|
| 01 | Storage deck with adjustable shelves | 01 | 01 |
| 02 | Storage deck with perforated panels | 02 | 03 |
| 03 | Heavy duty movable platform | 03 | 04 |
| 04 | Perforated panel | 04 | 01 |
| 05 | Secured enclosure with shelving | 05 | 02 |
| 06 | Pallet racking system | 06 | 02 |
| 07 | Shelving system with sliding shutter | 07 | 01 |
| 08 | Heavy duty shelving system | 08 | 02 |

1. Storage deck with adjustable shelves (**Drg.No.1**) -quantity: **01No.**
 - a. Galvanized MS structure with overall dimension 2000(H)x750(W)x555mm(D).
 - b. Total number of shelves=7.
 - c. 05Nos. of adjustable shelves with load capacity of 50kg each.
 - d. 02Nos. of shelves with load capacity of 100kg.
 - e. Containers are hence arranged in 08Nos. rows (Including 01No. base row)
 - f. Container fixing bars=12Nos.
 - g. 48 small containers, 25 Medium containers and 9 large containers. All containers are plastic.
 - h. Cylinder lock and 2 keys.
 - i. Hinged doors (2Nos. on either side) in solid metal sheet with perforated panels for the application of containers.
2. Storage deck with perforated panels (**Drg.No.2**) -quantity: **03Nos.**
 - a. Galvanized MS Structure with overall dimension 2000(H)x1023(W)x555mm(D).
 - b. One adjustable shelf with load capacity-25kg.
 - c. 4Nos. of perforated panels each with load capacity 40kg.
 - d. Each individual door with perforated panels.
 - e. 1 set of 142 hooks (Medium size).
 - f. 1 set of 13 hooks(Large size)
 - g. Cylinder lock and 2 keys.
 - h. Hinged doors (2Nos. on either side) in solid metal sheet with perforated panels for the application of hooks for holding tools.
3. **Heavy duty movable platform (Drg. No.3)** -quantity: **04Nos.**
 - a. Galvanized MS structure with overall dimension 1023(W)x1430(H)x613(W).
 - b. Load capacity of 300kg.
 - c. All shelves and base are to be made of galvanized MS plates.

- d. 04Nos. of rollers with brakes for easy movement of trolley.
- e. Handle at the back side for trolley movement.
- f. 3Nos. of shelves for total 18Nos. of Small size containers.
- g. 2Nos. of shelves for total 8Nos. of Medium size containers.
- h. 01No. of shelves for 3Nos. of Large size containers.
- i. 03Nos. of large size containers are to be arranged in Bottom base row.
- j. Hence containers can be arranged in 7 rows (Including 01No. base row)

4. Perforated panel (Drg. No.4) –quantity: 01No.

- a. MS perforated panel: 2000(L)x600(H)mm
- b. This panel has to be fixed to an already existing wooden top mechanical workbench.
- c. Anchor bolts/screws have to be provided for attaching on to the workbench top.
- d. 01set of 100Nos. of hooks for arranging tools.

5. Secured enclosure with shelving (Drg.No.5) –quantity: 02Nos.

- a. Galvanized MS structure with overall dimension 2100(H)x 1200(W)x450(D)mm.
- b. 6Nos. of locker units arranged at the bottom in 2 rows. Hinged doors are to be provided.
- c. All locker units are to be of same dimension approximately 450(H)x400(W)mm.
- d. 3Nos. of rows are to be created on top of the locker unit.

6. Pallet racking system (Drg.No.6) –quantity: 02Nos.

- a. Galvanized MS structure with overall dimension 2800(W)x2200(H)x800(D)mm.
- b. The racking system has to be of easy dismountable type with no welding joints.
- c. Each pallet should have load capacity of 400kg.
- d. Each pallet should be able to slide along the rack without any unbalance of rack.
- e. All safety precautions must be taken to ensure no toppling of rack during loading and unloading of weights.
- f. Hydraulic stackers will be used to slide the load in and out of the rack. The stacker can carry 1Ton capacity at its base and 600kg at 1m height.
- g. The load is a rectangular block (weight 250kg) having approximate dimensions of 400x450x760mm. 400kg load capacity is given for safe design.
- h. Design has to incorporate 9-12 boxes in the rack. Approximate dimensions are shown in the drawing. (Vendor may visit the site and take dimensions).
- i. Cross bars must be given at appropriate locations for structural integrity.

7. Shelving system with sliding shutter (Drg.No.7) –quantity: 01No.

- a. Material: Galvanized MS structure
- b. Overall dimension 2195(H)x1358(W)x332(D)mm.
- c. Sliding door arrangement with central lock and key.
- d. 7Nos. of adjustable shelves are to be given. Each with load capacity of 100kg.
- e. The shelves are closed from all sides by MS sheets.

- f. Available space between shelves must be at least 268mm when all shelves are arranged at equal distances.
- g. Nylon bushes at legs to prevent scratching of floor area.

8. Heavy duty shelving system (Drg.No.8) –quantity: 02No.

- a. Material: Galvanized MS structure with overall dimension 2200(H)x1500(W)x800(D)mm.
- b. 3Nos. of adjustable shelves are to be given. Each with 1000kg UDL capacity.
- c. Available space between shelves is 690mm.
- d. Proper base has to be given to prevent crushing of floor and scratching.
- e. System is open on all sides. Proper cross bars are given on side edges for structural integrity.

Note to the vendor:

- 1. All dimensions are indicative.
- 2. It is **mandatory** for the vendor to visit the purchaser's site and note the measurements before submitting quotation.
- 3. The vendor has to share updated drawings along with the quotation.
- 4. Quotations not satisfying the above conditions (02 and 03) **will not be accepted**.
- 5. Installation these components are to be done at the purchaser's site.
- 6. Necessary fasteners for the purpose are to be supplied by the vendor.
- 7. Loading/unloading of materials is under the scope of supplier.
- 8. Vendor has to depute qualified fitters for installation purpose.
- 9. All safety measures (Helmets, gloves, goggles, safety shoes etc.) must be taken by fitters during installation.
- 10. It is mandatory to mention prices of each item separately plus the cost of transportation and installation.

GENERAL REQUIREMENTS:

- a) The vendors are encouraged to hold prior discussions with the indenter for any clarifications.
- b) Finished products should be delivered to the address given below.

Address:

"Stores Officer, Bhabha Atomic Research Center, Near Nagavaram Junction, Nagavaram-Atchutapuram Highway, Visakhapatnam, Andhra Pradesh- 531011"

- c) The cost of transportation/delivery if any should be mentioned in the quotation.
- d) It is mandatory to mention prices of each item separately.
- e) Single order will be placed for all the above items and no partial work is permitted.
- f) Minimum Guarantee/**Warranty period** of the raw material and workmanship shall be **One Year**.
- g) **Contact Persons:**

- a) **Shri. Rahulnath P.P.**, Computational Analysis Division, BARC
Contact details: rahulnath@barc.gov.in
Phone: 0891-283-2149, 8985875318



(Rahulnath P.P.)
SO/D, CAD

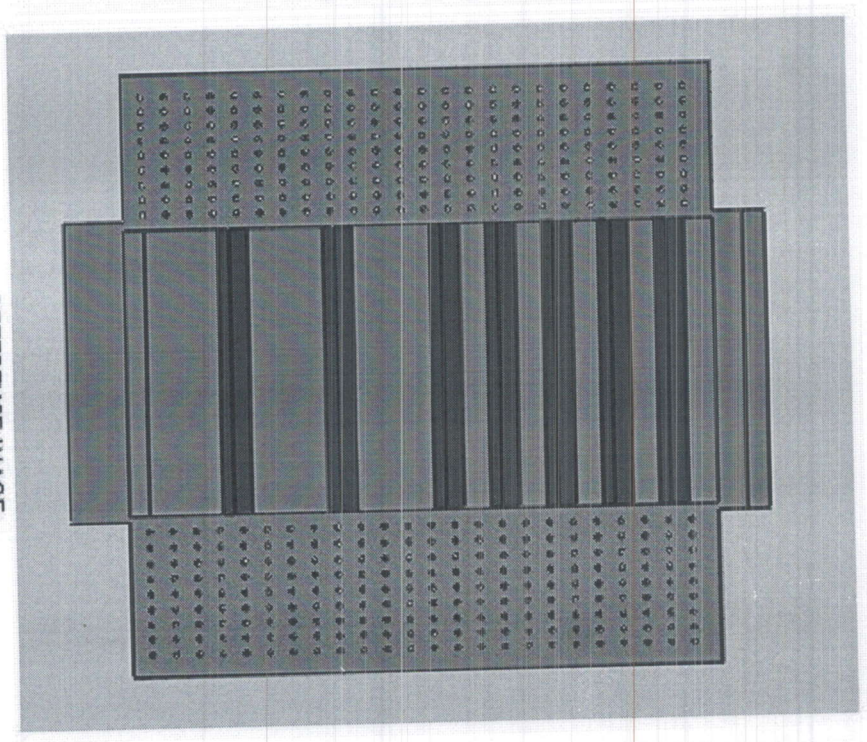
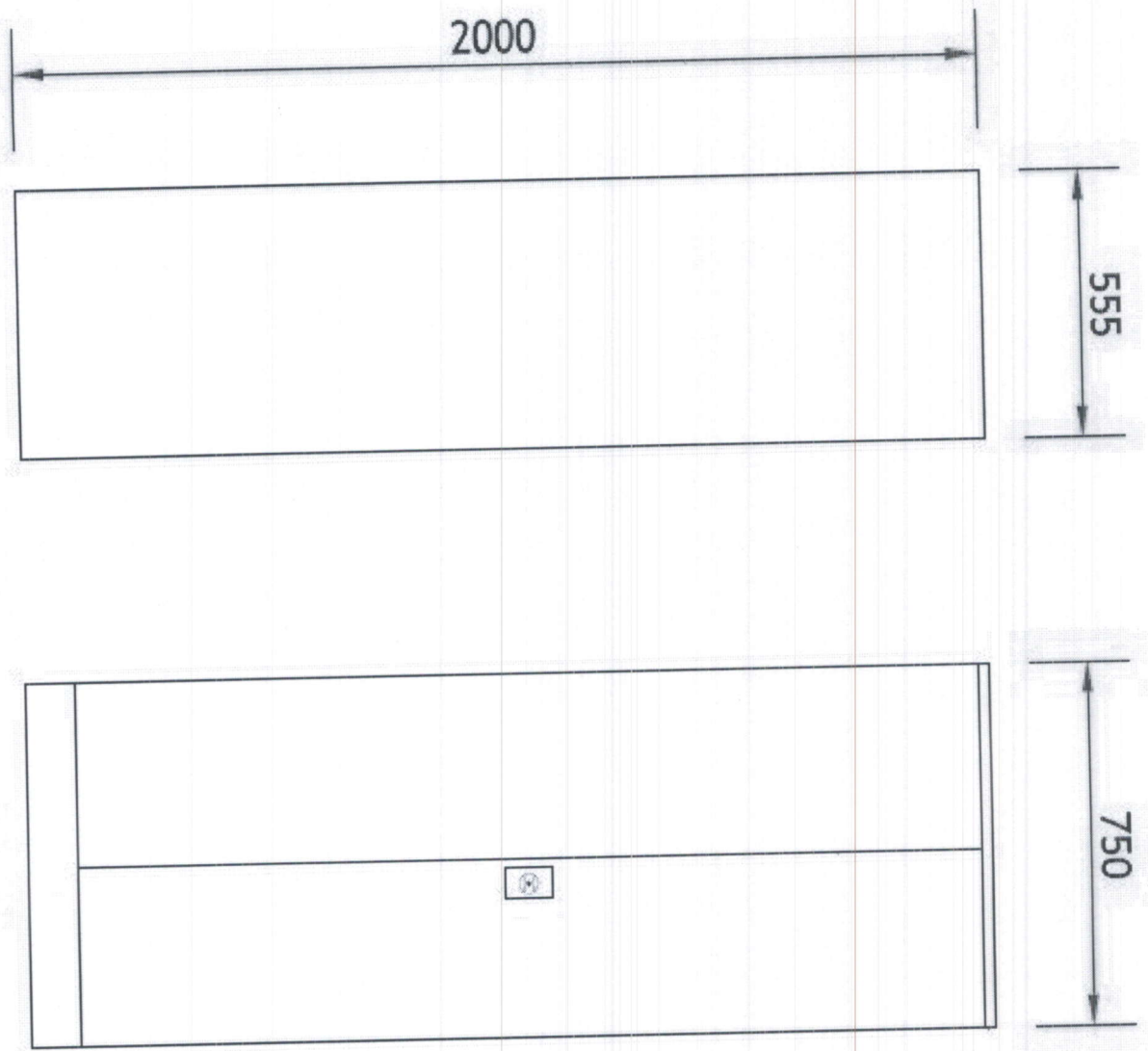

Drg.No.1_Steel cabinet with adjustable shelves

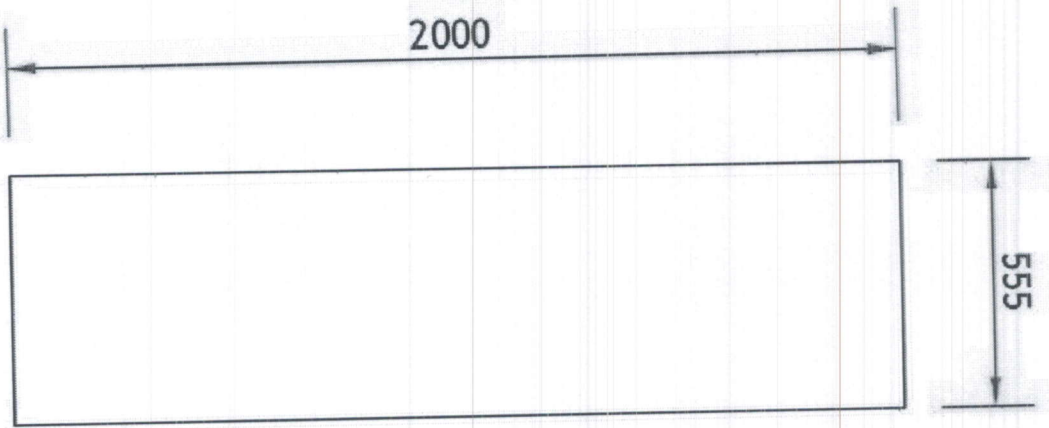

SIDE VIEW

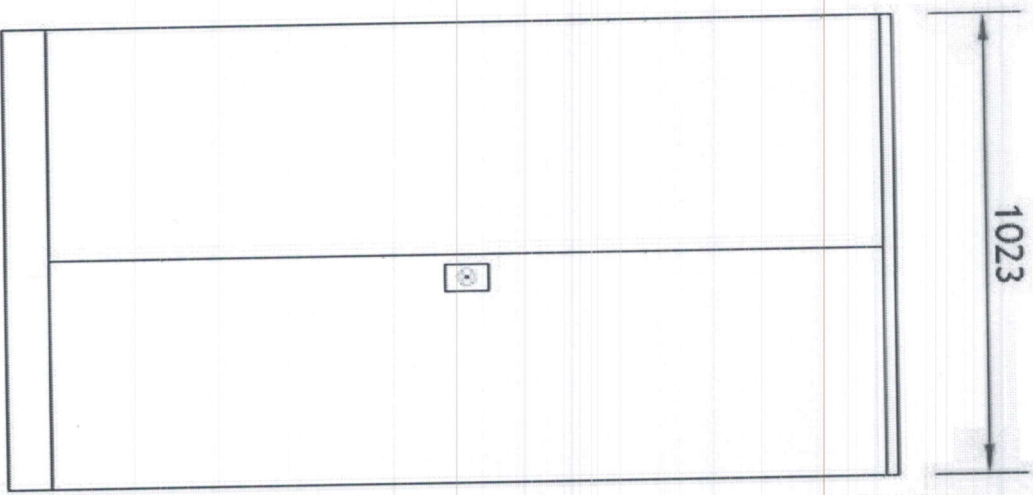

FRONT VIEW

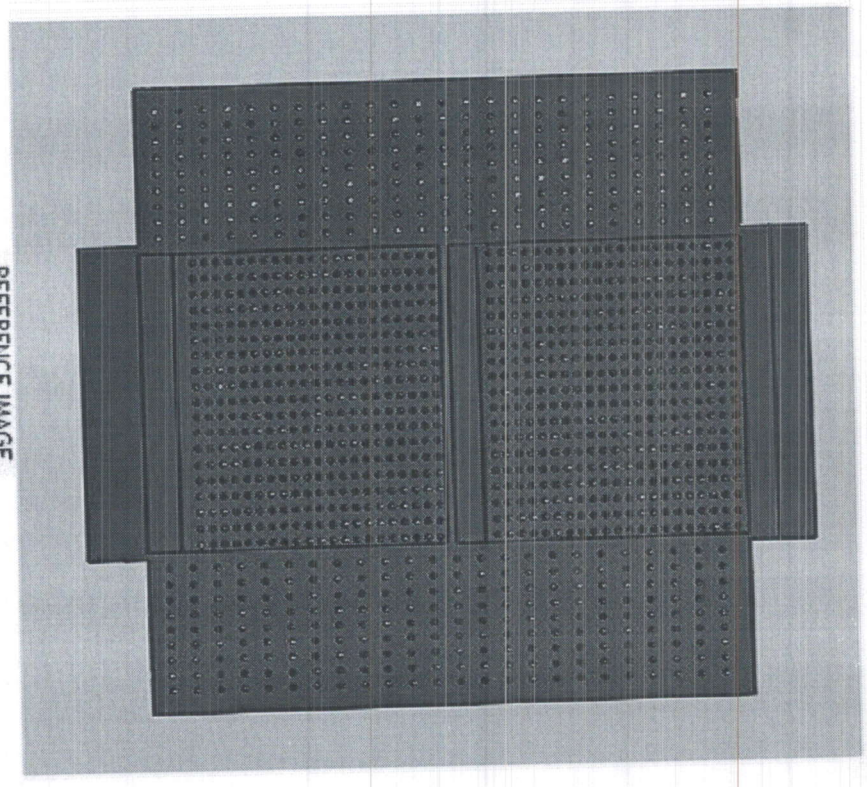

REFERENCE IMAGE

Drg.No.2_Steel cabinet with perforated panels

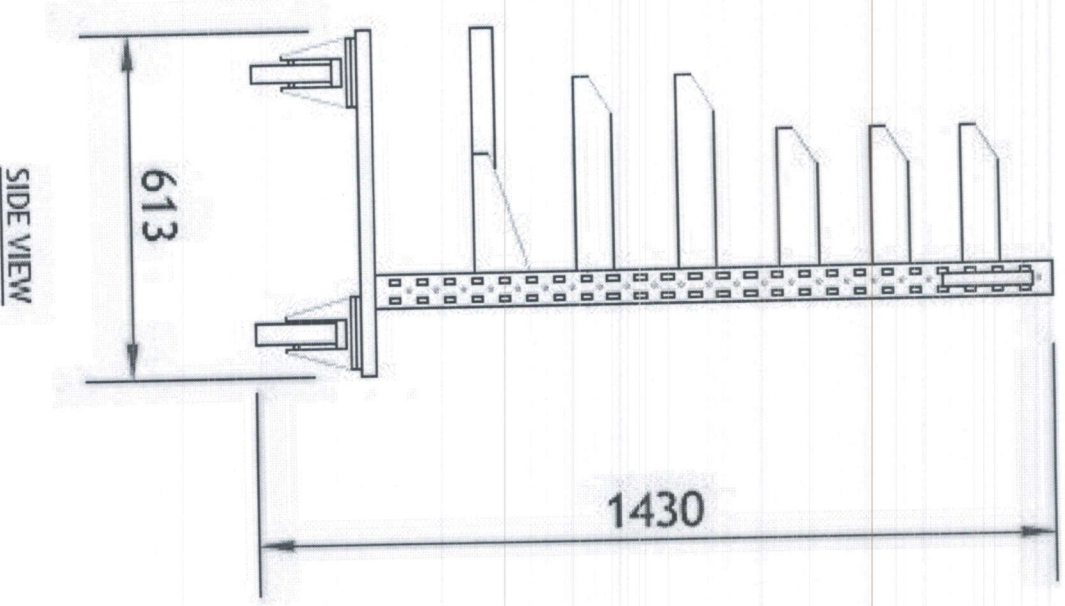

SIDE VIEW

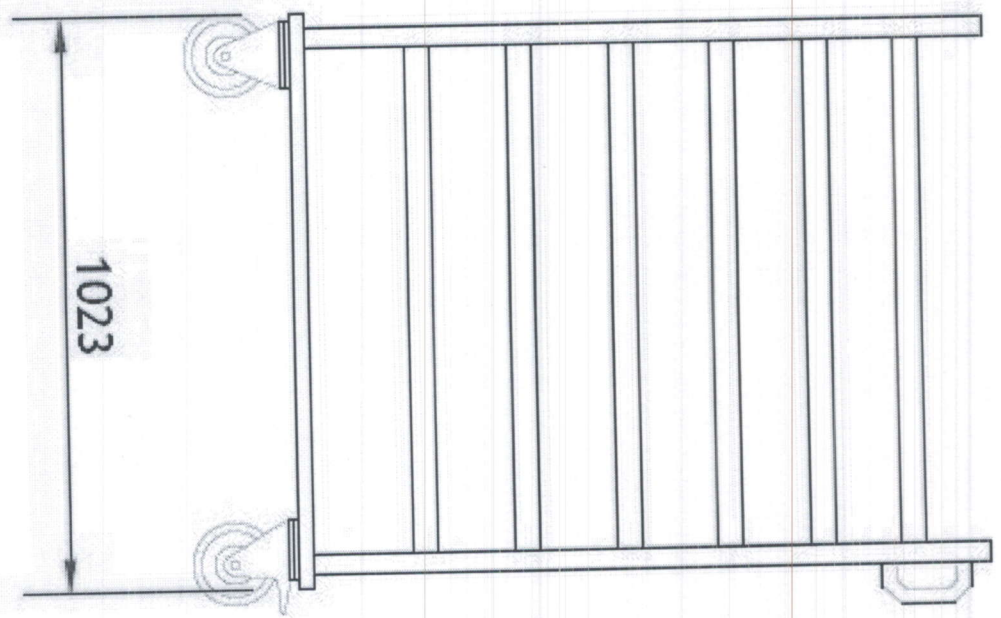

FRONT VIEW

Drg.No.3_Industrial trolley

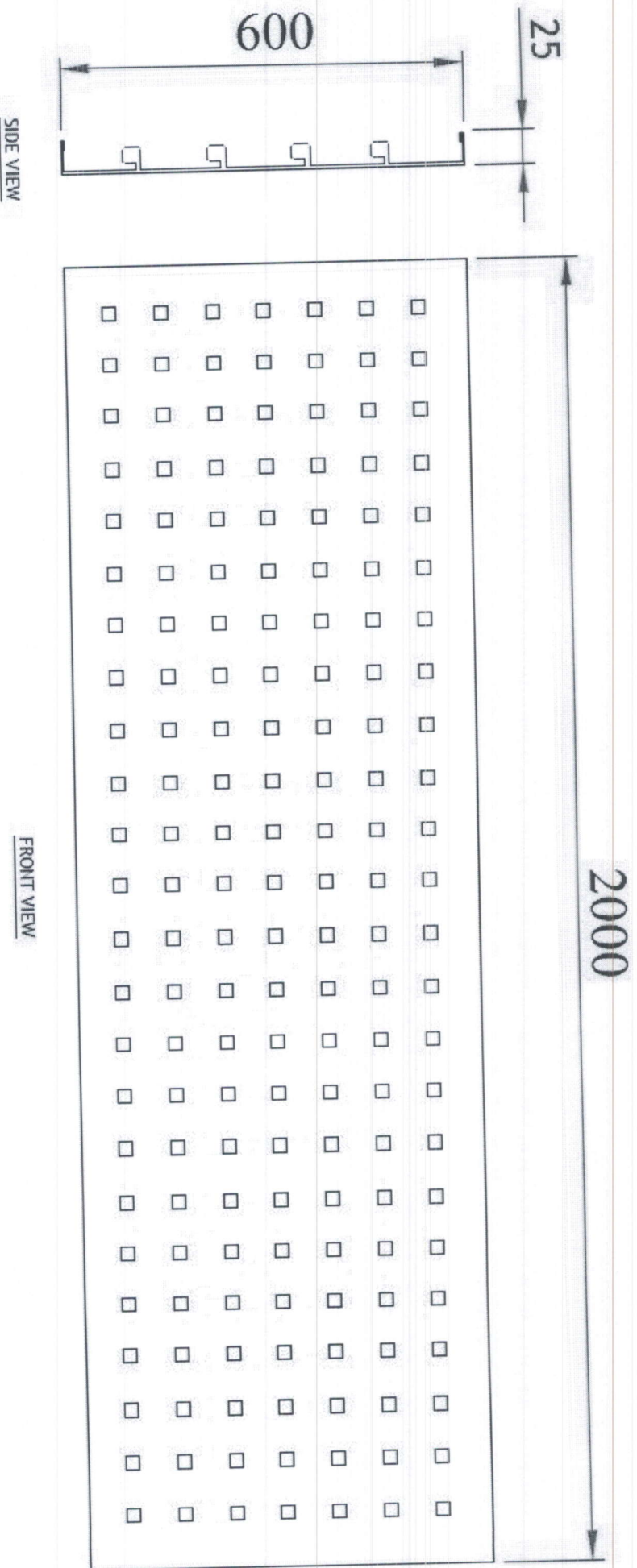

Drg.No.4_perforated Panel

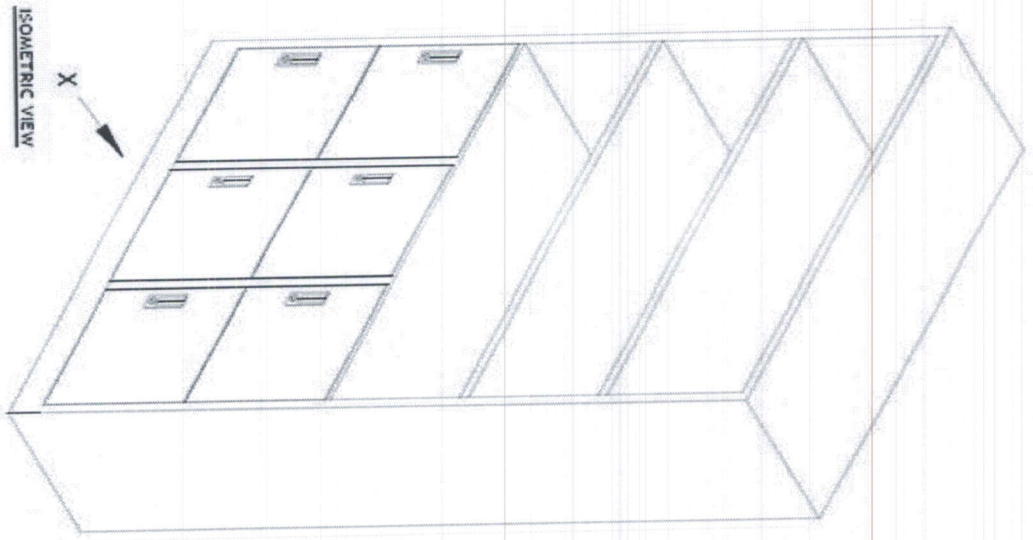
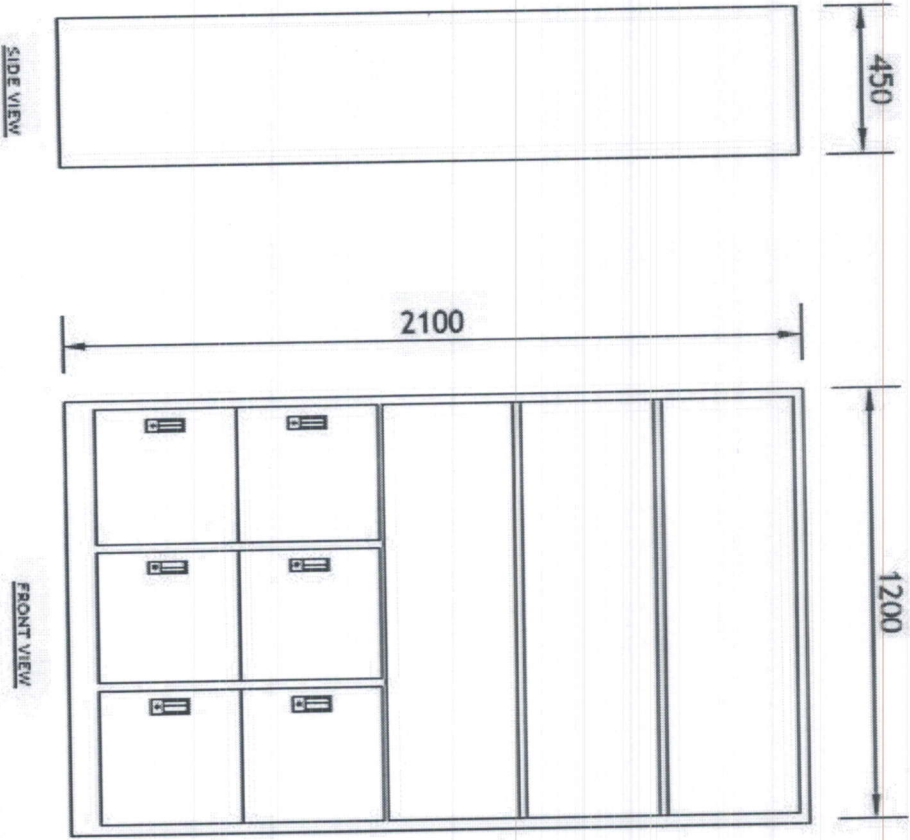

Drg.No5_Locker unit with two shelves

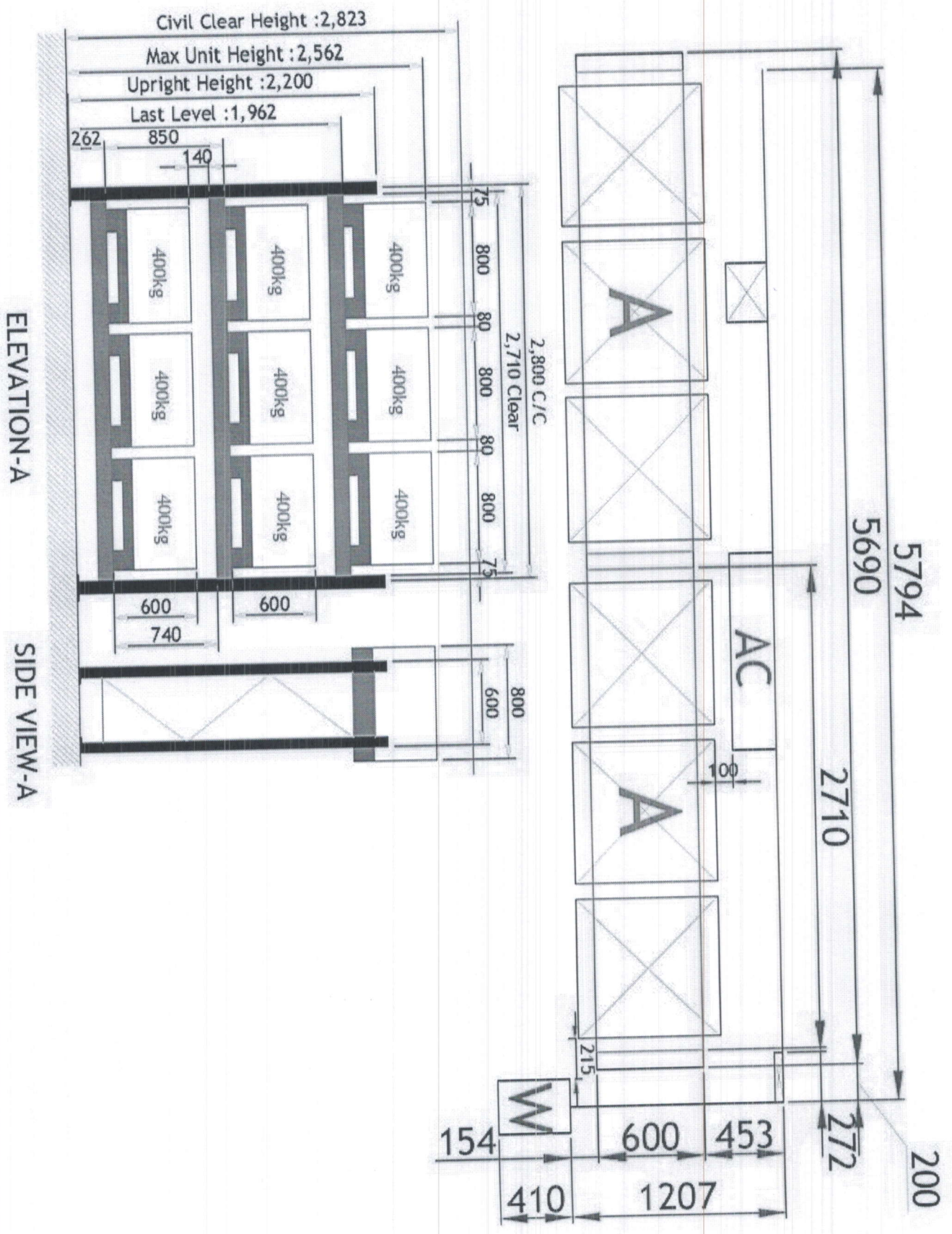

Drq.No.6_Pallet racking system

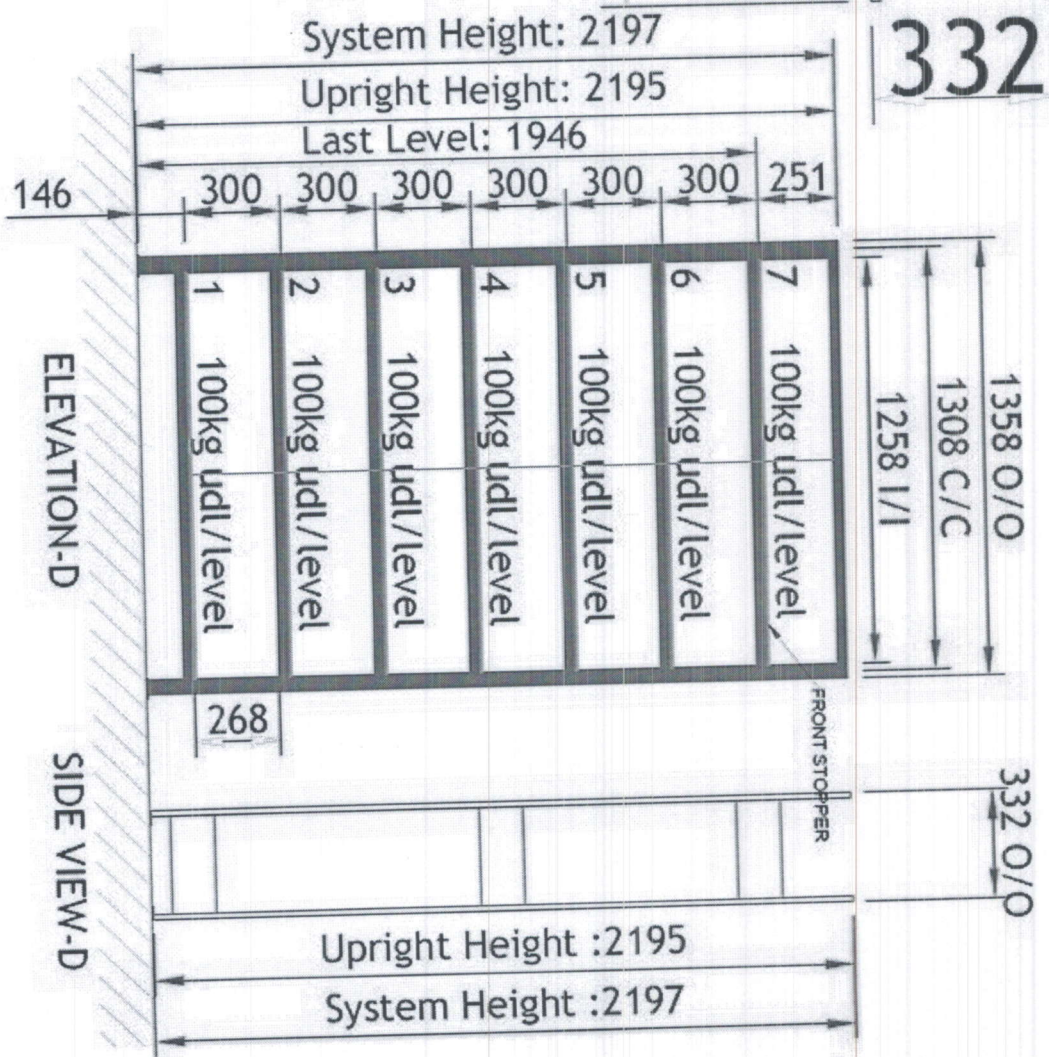
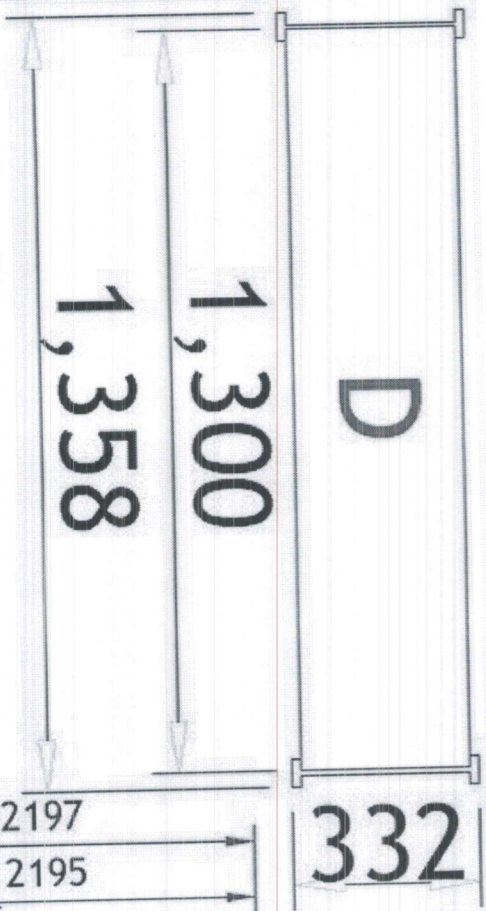
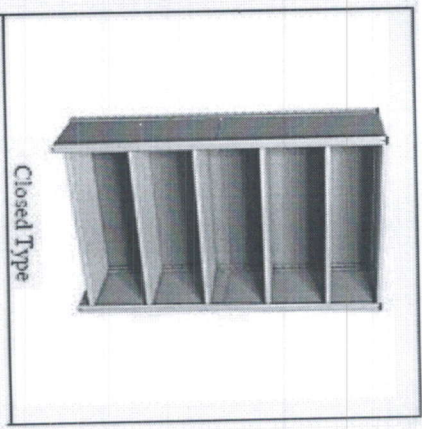

Drg.No.7_Shelving system with sliding shutter

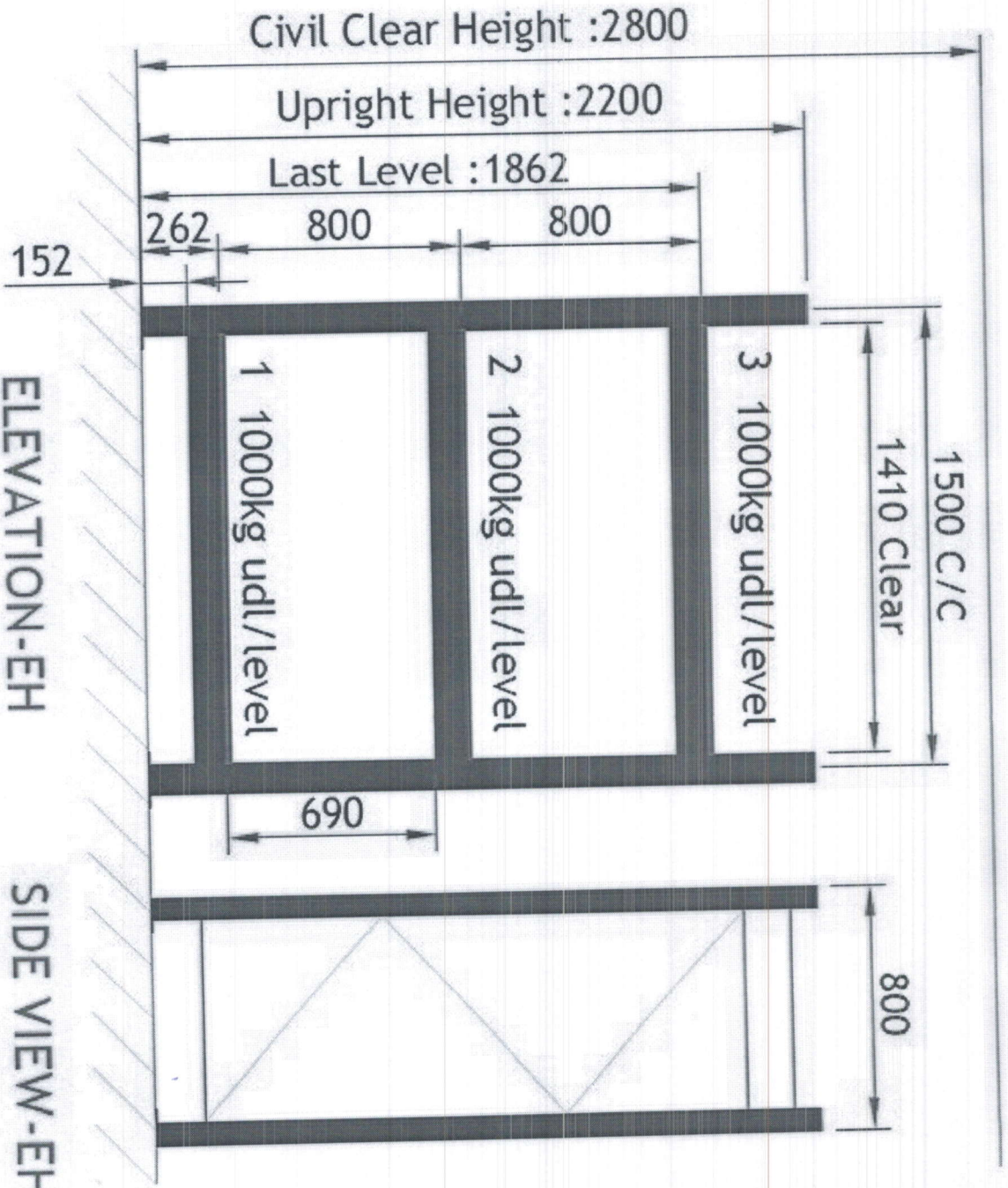

Drq.No.8_Heavy duty shelving system