

दूरभाष :
TELEPHONE :
तार : बार्क-मुंबई, चेम्बुर.
TELEGRAMS: BARC-MUMBAI, CHEMBUR.
टेलिक्स : ०११-६१०१७/०११-६१०२२ बार्क ईन
TELEX: 011-61017/011-61022 BARC IN
फेक्स संख्या : ११ - २२ - ५५० ५१५१
FAX NUMBER: 91-22-5505151



सत्यमेव जयते

भारत सरकार
GOVERNMENT OF INDIA

भाभा परमाणु अनुसंधान केन्द्र
BHABHA ATOMIC RESEARCH CENTRE
Solid State Physics Division

ट्रॉम्बे,
मुंबई-४०० ०८५.
TROMBAY,
MUMBAI-400 085.

Ref: SSPD/

17/01/2022

Sub.: Invitation of quotations for “**Supply and installation of the stainless Steel (SS-304) plate (Quantity: one)**” as per the specifications in Annexure-1.

Due Date: January 30, 2022

Dear Sirs,

Sealed quotations are hereby invited for the supply of “**supply and installation of the stainless Steel (SS-304) plate (Quantity: one)**” as per the specifications in Annexure-1.

The quotations must reach, Head, Solid State Physics Division on or before the due date referred above and must be sent in a sealed envelope superscribed with the above reference number and due date.

The address on the envelope should read:

Solid State Physics Division (MODLABS),
Bhabha Atomic Research Centre
Mumbai - 400 085.
Attn : Mr. Anil Jain

Quotations not accompanied by PAN and GST numbers are liable to be rejected.

1. Scope and Technical Specification –

Supply and installation of the stainless Steel (SS-304) plate (Quantity: one) as per the specifications in Annexure-1

2. **Completion period-** The time allowed for supplying and installation of the items will be 45 days from the date of the firm purchase order issued to the bidder. The finished components shall be delivered at BARC, Trombay, Mumbai-400 085.

3. Commercial terms & conditions

- 3.1 Release of advance/part payment will not be considered
Full payment will be made after satisfactory completion of the entire work as specified hereinabove and submission of the following documents:
 - 3.1.1 Delivery Challan
 - 3.1.2 Bill in duplicate
 - 3.1.3 Advance stamped receipt
 - 3.1.4 Guarantee certificate.
 - 3.1.5 Test certificates.
- 3.2 Income tax @ 2% and SC on IT as applicable will be deducted from your bill amount.
- 3.3 TDS certificate will be issued by BARC if desired.

Security Instructions

- 3.4 Please indicate whether any of your relatives are employed in BARC or you or any of your employees were employed in BARC or any other units of DAE.
- 3.5 All identity cards/temporary entry permits issued by BARC to you and your employees shall be returned immediately on completion of work.

4.0 Confidentiality Clauses.

4.1 Confidentiality:

No party shall disclose any information to any third party concerning the matters under this contract generally. In particular, any information identified as “Proprietary” in nature by the disclosing party shall be kept strictly confidential by the receiving party and shall not be disclosed to any third party without prior written consent of the original disclosing party. This clause shall apply to the sub-contractors, consultants, advisers or the employees engaged by a party with equal force.

4.2 “Restricted information” categories under section 18 of the Atomic Energy Act, 1962 and “Official Secrets” under Section 5 of the Official Secrets Act, 1923 :-

Any contravention of the above mentioned provisions by any contractor, sub-Contractor, consultant, adviser or the employees of a contractor will invite penal consequences under the aforesaid legislation.

4.3 Prohibition against use of BARC’s name without permission for publicity purposes: -

The contractor or sub-contractor, consultant, adviser or the employees engaged by the contractor shall not use BARC’s name for any publicity purpose through any public media like Press, Radio, T.V. or Internet without the prior written approval of BARC.

5.0 General:

- 5.1 All other terms and condition of the contract shall be as per the standard format of tender document prevailing in the BARC.
- 5.2 Proof of ability: No tender will be considered unless the bidder can satisfy the purchaser that he can meet time schedule and technical requirement. Contractors experienced in
- 6.0 The quotations should be in figures as well as in words and should mention the rates and amounts. All corrections shall be attested with date and initials of the bidder.
- 7.0 All quotations in which any of the prescribed conditions are not fulfilled or incomplete in any respect are liable to be rejected.
- 8.0 Sales tax/ General taxes/ Excise duties where legally leviable and intended to be claimed should be distinctly shown along with the price quoted. Where this is not done, no claim for sales/ general taxes will be admitted at any later stage and on any ground whatsoever. Form H shall be provided where necessary.
- 9.0 It will be obligatory on the part of the bidder to quote and sign the quotation documents.
- 10.0 Payment will be made by cheque only after supplying the items on production of bill, delivery challan and advance stamped receipt.
- 11.0 The stainless Steel (SS-304) plate will be guaranteed against material and manufacturing defects for **12 months** from the date of commissioning successfully.
- 12.0 Necessary GST concession certificate (*Applicable Concessional rate of GST : 5%*) will be provided by the Purchaser after placement of the order prior to despatch of the material.

Thanking you,



Yours sincerely,

(Anil Jain)

SO/G, SSPD, BARC

Encl. 1. Annexure-1 (with drawing)

Annexure-1

Detail specifications regarding the supply and installation of the stainless Steel (SS-304) plate (Quantity: one)

1. Plate (quantity: one) must be as per the dimensions mentioned in the Drawing.
2. Plate has to be in single piece without welding.
3. All dimensions in the Drawing are in mm and scale-1:1.
4. General tolerances shall be - On length up to 300 mm- +/-2.0 mm; Above 300 mm & including 2000 mm- +/-5.0 mm, Over 2000 mm- +/-8.0 mm.
5. Straightness and flatness of the base plate should be maintained.
6. Surface finish should be maintained within 50-100 microns.
7. All burrs should be removed.
8. All sharp corners & edges should be rounded off.
9. Supplier should provide lifting hooks for the movement of the plate and the hooks must be removed after the installation.
10. Physical movement and installation of the base plate at the workplace will be carried out by the supplier with proper safety protocols.
11. Supplier will provide guarantee period 12 months from the date of supply against any manufacturing defects.

Anil Jain
SO/G, SSPD, BARC
(Indenting Officer)



Details of 'A'
(Scale: 1:4)

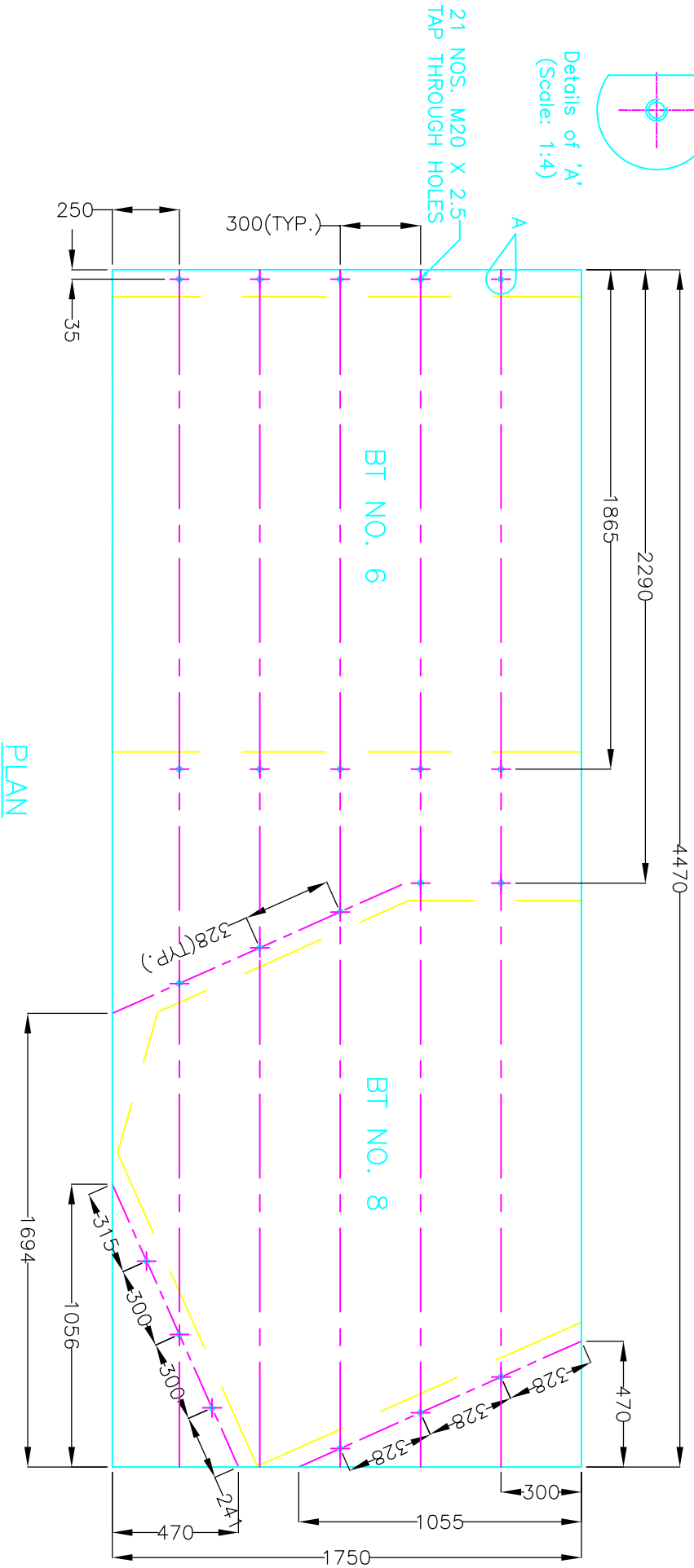

NOTE:-

1. All dimensions are in mm and scale—1:1.
2. General tolerances shall be — on length upto 300mm— $\pm 2.0\text{mm}$ above 300mm & including 2000mm— $\pm 5.0\text{mm}$ over 2000mm— $\pm 8\text{mm}$.
3. Straightness and flatness of the base plate should be maintained.
4. Surface finish should be maintained 50—100 microns.
5. All burrs should be removed.
6. All sharp corners & edges should be rounded off.
7. Physical movement and installation of the base plate at the workplace should be handled by the supplier followed with safety protocols.

BASE PLATE FOR SHIELDING BLOCKS

Material: SS-304
Base Plate Dimensions: 4470mmX1750mmX30mm THK.
Total Area: 7.822 sq. m
Total Moss:~ 1,816 kg

BILL OF MATERIAL

| Sl. NO. | DESCRIPTION | MATERIAL | QTY. | REMARKS |
|---------|-----------------------------------|----------|--------|---------|
| 1 | BASE PLATE (4470X1750X30 THK.) | SS-304 | 1 No. | |
| 2 | EYE BOLTS (M20 X 2.5) for lifting | SS | 10 Nos | |